

**DISPOSIZIONE CANALI DIMMER**  
**SALONE TEATRALE GESÙ BUON PASTORE**  
CONFIGURAZIONE A

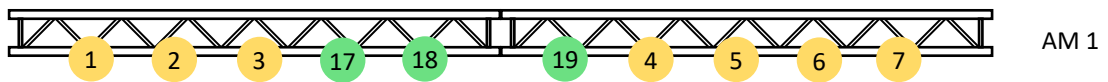
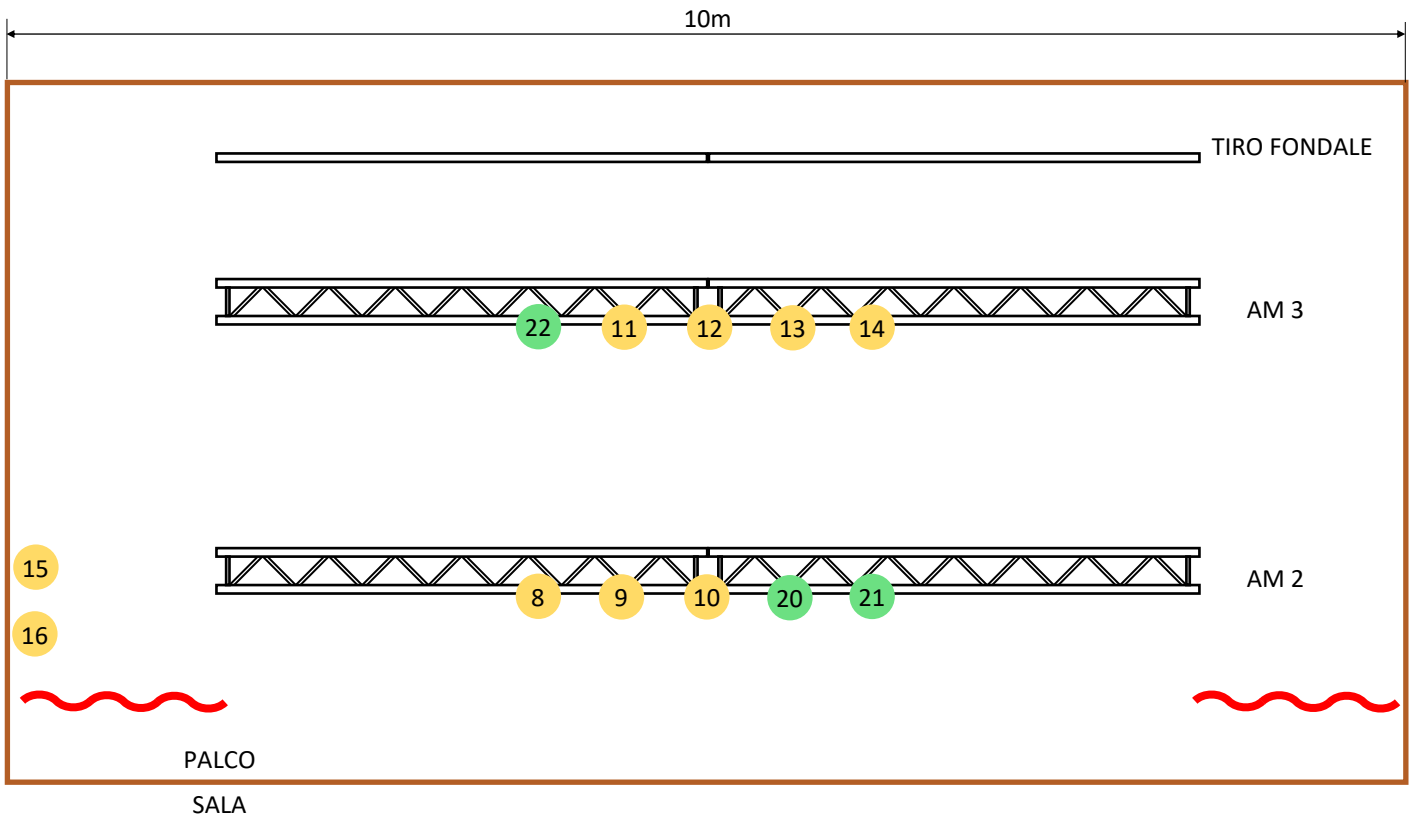

15 RIMANDO GALLERIA

LEGENDA	
<span style="color: green;">●</span>	Canale dimmer <b>3,6kW</b>
<span style="color: orange;">●</span>	Canale dimmer <b>1kW</b>

Carico elettrico massimo complessivo: <b>22kW</b>
Portata americane per fari: <b>16kg/m</b>

**DISPOSIZIONE CANALI DIMMER**  
**SALONE TEATRALE GESÙ BUON PASTORE**  
CONFIGURAZIONE B

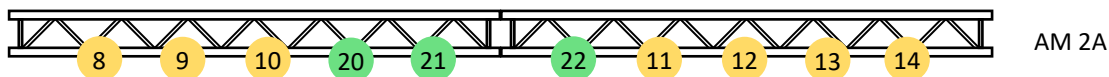
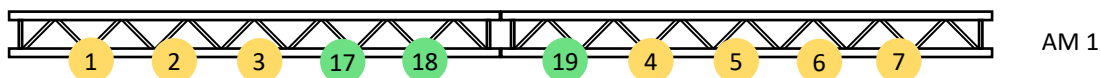
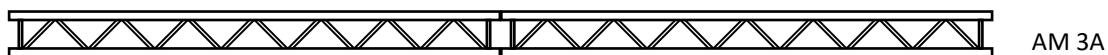
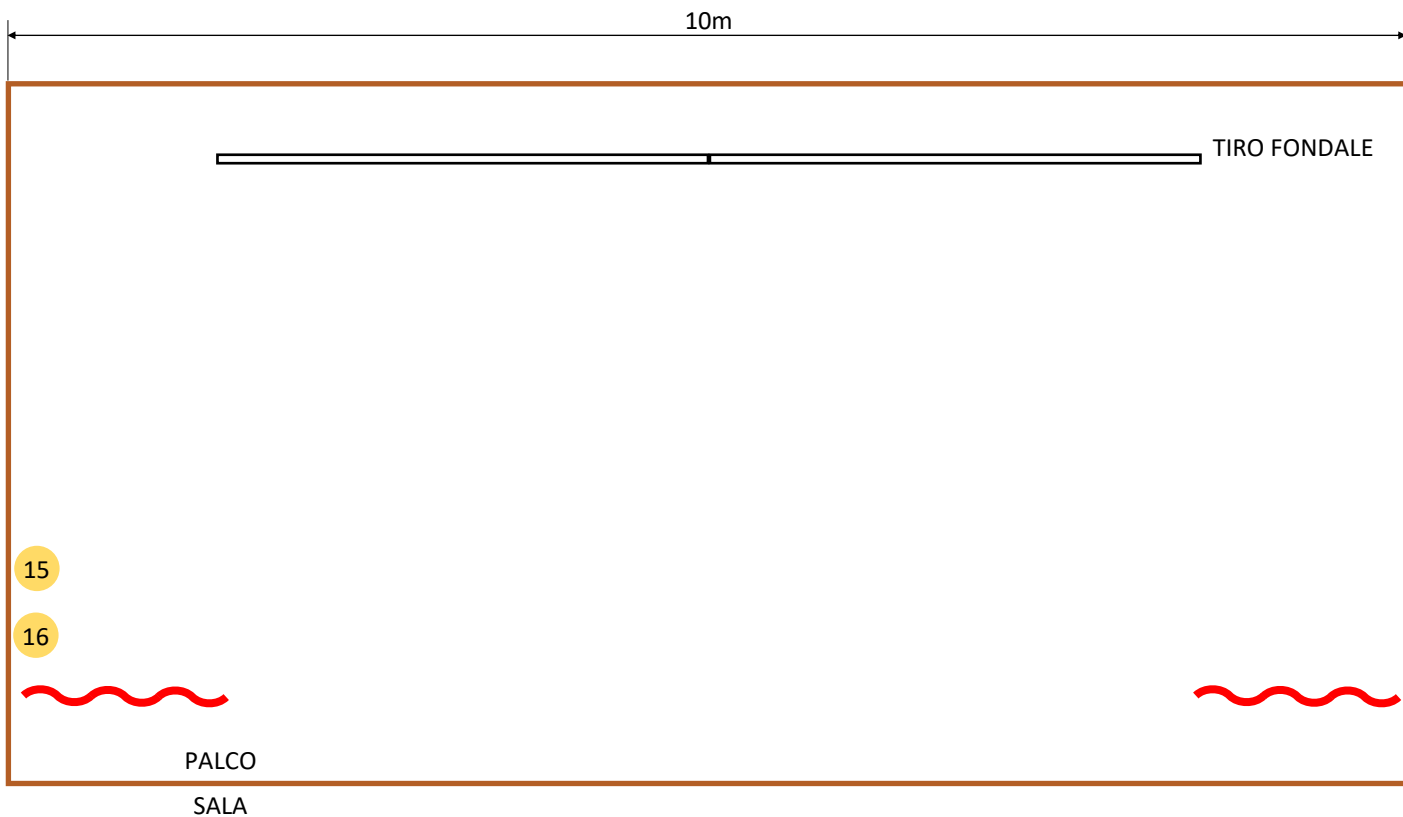

15 RIMANDO GALLERIA

LEGENDA	
<span style="color: green;">●</span> xx	Canale dimmer <b>3,6kW</b>
<span style="color: orange;">●</span> xx	Canale dimmer <b>1kW</b>

Carico elettrico massimo complessivo: <b>22kW</b>
Portata americane per fari: <b>16kg/m</b>